



RMS Building,
Heapham Road Ind Est
Gainsborough,
Lincolnshire,
DN21 1RZ

Tel/Fax: 01427 811095
Mobile: 07918731908 / 9
email: sales@liftsafesolutions.co.uk

LATERAL LIFTING CLAMP (Lock handle type)



HLC 0.5H ~ 5H

Clamp for lateral (horizontal) lifting of steel plates and structural steels (H, I, T and L shaped steel structures)

FEATURES

- The spring-loaded tightening lock mechanism assures a positive initial clamping force.
- The clamping force increases in proportion to the weight of the load.
- The main body is made from die-forged special alloy steels, which is optimally tempered for maximum strength and durability.
- High-frequency quenching of die-forged special alloy steels gives greater durability to the cam.
- The main body is a baked-on finished
- The handle makes it easy and safe to set and detach the clamp onto and from the work piece.

SPECIFICATIONS

Item No.	Rated capacity (ton)	Jaw opening (mm)	Net weight (kg)	Remarks
HLC 0.5H	0.5	0~25	3.0	
HLC 1H	1	0~30	5.5	
HLC 1WH	1	0~40	5.9	
HLC 2H	2	0~35	9.5	
HLC 3H	3	0~40	13.5	
HLC 5H	5	0~45	23	

EXAMPLES OF USE

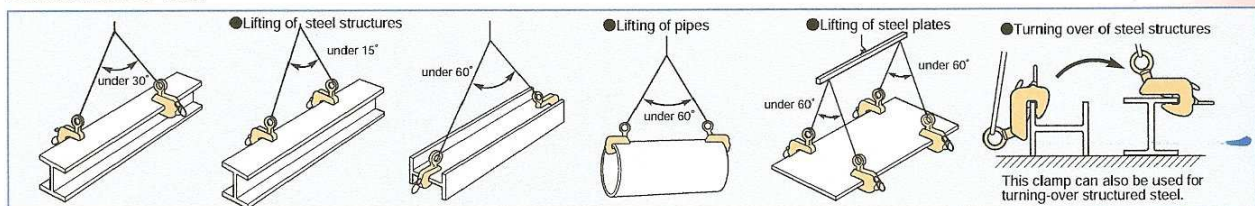

Always lift work pieces at 2 or more points for safety.

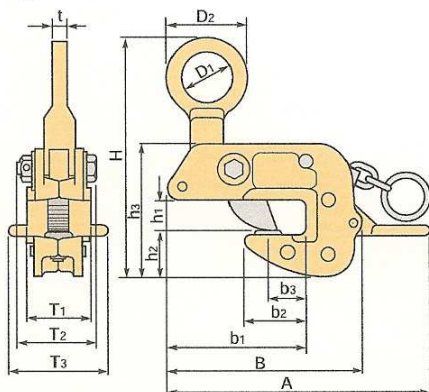

DIMENSIONS TABLE

(Unit:mm)

Item No.	H (MAX.)	h1	h2	h3	b1	b2	b3	A	B	D1	D2	t	T1	T2	T3
HLC 0.5H	208	27	38	115	122	56	34	229	173	40	65	12	49	65	86
HLC 1H	246	32	48	140	143	65	40	273	203	50	80	16	61	80	104
HLC 1WH	229	43	56	161	151	62	35	262	209	50	80	16	64	68	100
HLC 2H	292	37	58	168	162	74	45	307	237	60	100	18	75	93	104
HLC 3H	337	42	68	195	181	83	50	350	270	70	120	20	87	106	118
HLC 5H	385	47	81	222	212	90	55	380	312	80	140	22	102	118	134

※ The main bodies of HLC-1WH and HLC-5H are made of high-tensile steel plates.